

DOOR TYPE	DESCRIPTION
CP - CLAD SLIDING GLASS DOOR	ONE PANEL STATIONARY

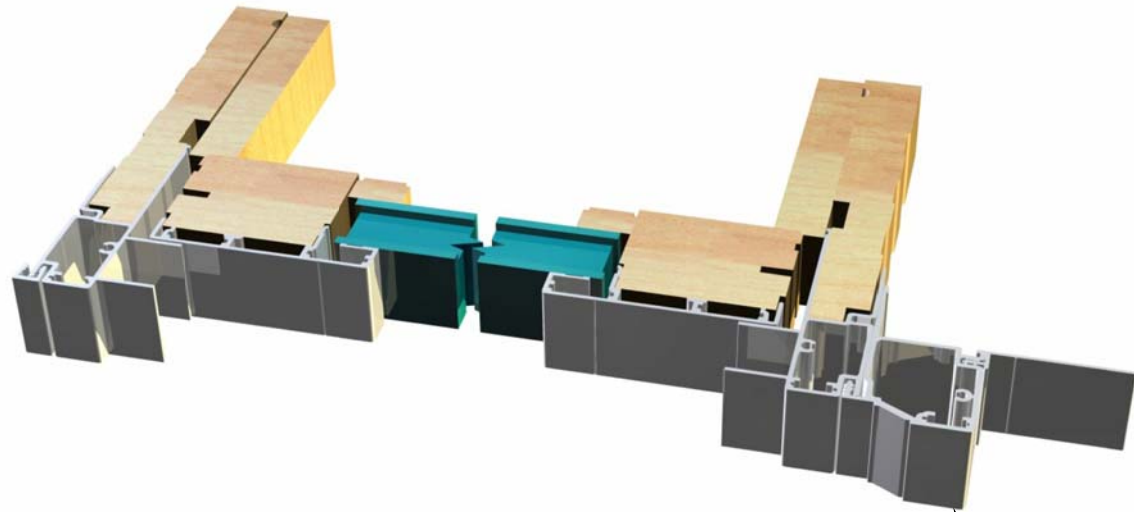

Optional Brickmould

Alone or to be used with two panel unit for OXO, OOX, or XOO

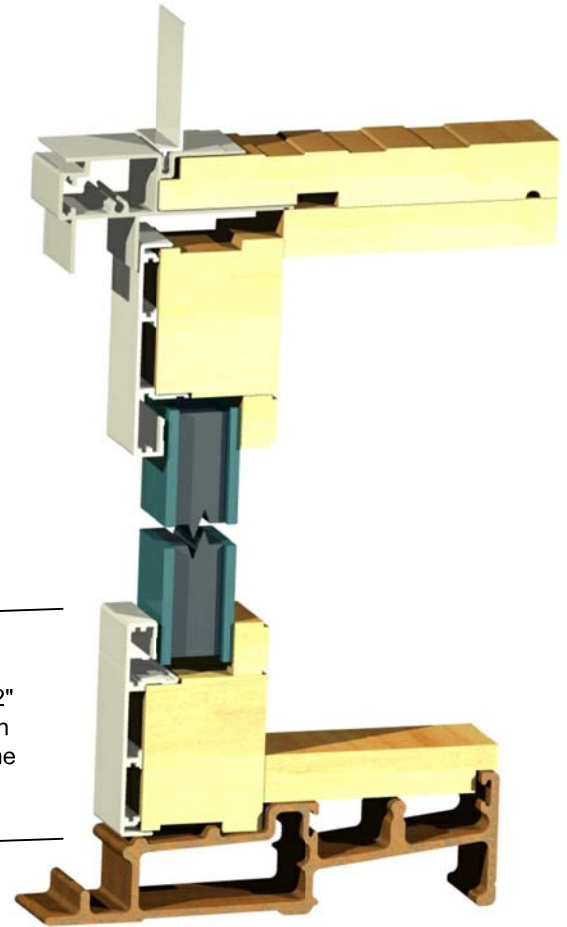
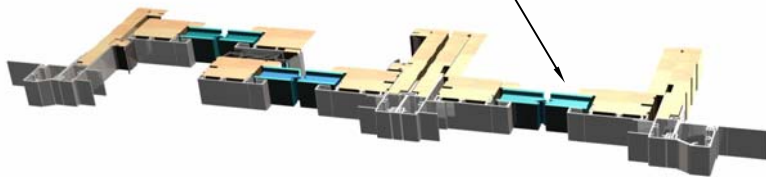

2-1/2"
Sash
Frame

Head/Sill Section

Scale: 1/4"=1"



Exterior Elevation

Scale: 1/2"=1'-0"

UNIT	OSM FRAME:	OSM OPTIONAL BRICKMOULD
CPSL2-6x6/9	31-5/8" x 80-1/16"	33-15/16" x 81-7/32"
CPSL3x6/9	37-5/8" x 80-1/16"	39-15/16" x 81-7/32"
CPSL4x6/9	49-5/8" x 80-1/16"	51-15/16" x 81-7/32"
CPSL2-6x6/11	31-5/8" x 82-1/16"	33-15/16" x 83-7/32"
CPSL3x6/11	37-5/8" x 82-1/16"	39-15/16" x 83-7/32"
CPSL4x6/11	49-5/8" x 82-1/16"	51-15/16" x 83-7/32"
CP2-6x8/0	31-5/8" x 95-1/16"	33-15/16" x 96-7/32"
CP3x8/0	37-5/8" x 95-1/16"	39-15/16" x 96-7/32"
CP4 x 8/0	49-5/8" x 95-1/16"	51-15/16" x 96-7/32"
Custom	Available	Frame Width + 2-5/16" Frame Height + 1-5/32"



PARK VUE
Wood Swing and Sliding Doors

BY MERRILL MILLWORK

DOOR TYPE	DESCRIPTION
CP - CLAD SLIDING GLASS DOOR	TWO PANEL XO or OX



Optional Brickmould

Jamb Section
Scale: 1/4"=1"

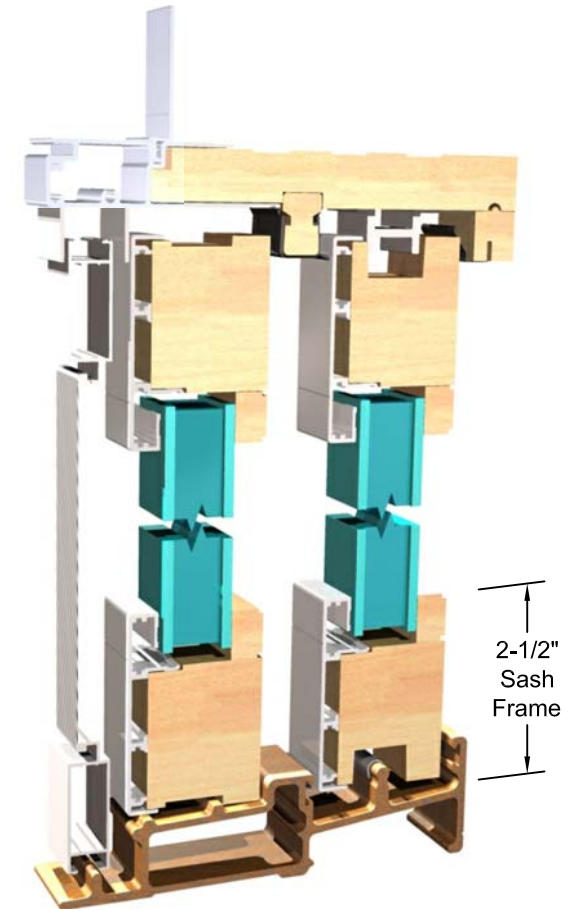

2-1/2"
Sash
Frame

Head/Sill Section
Scale: 1/4"=1"



Exterior Elevation
Scale: 1/2"=1'-0"

UNIT	OSM FRAME:	OSM OPTIONAL BRICKMOULD
CP5x6/9	58-7/8" x 80-1/16"	61-3/16" x 81-7/32"
CP6x6/9	70-7/8" x 80-1/16"	73-3/16" x 81-7/32"
CP8x6/9	94-7/8" x 80-1/16"	97-3/16" x 81-7/32"
CP5x6/11	58-7/8" x 82-1/16"	61-3/16" x 83-7/32"
CP6x6/11	70-7/8" x 82-1/16"	73-3/16" x 83-7/32"
CP8x6/11	94-7/8" x 82-1/16"	97-3/16" x 83-7/32"
CP5x8/0	58-7/8" x 95-1/16"	61-3/16" x 96-7/32"
CP6x8/0	70-7/8" x 95-1/16"	73-3/16" x 96-7/32"
CP8x8/0	94-7/8" x 95-1/16"	97-3/16" x 96-7/32"
Custom	Available	Frame Width + 2-5/16" Frame Height + 1-5/32"



BY MERRILL MILLWORK

DOOR TYPE	DESCRIPTION
CP - CLAD SLIDING GLASS DOOR	THREE PANEL XO0, OX0, OOX

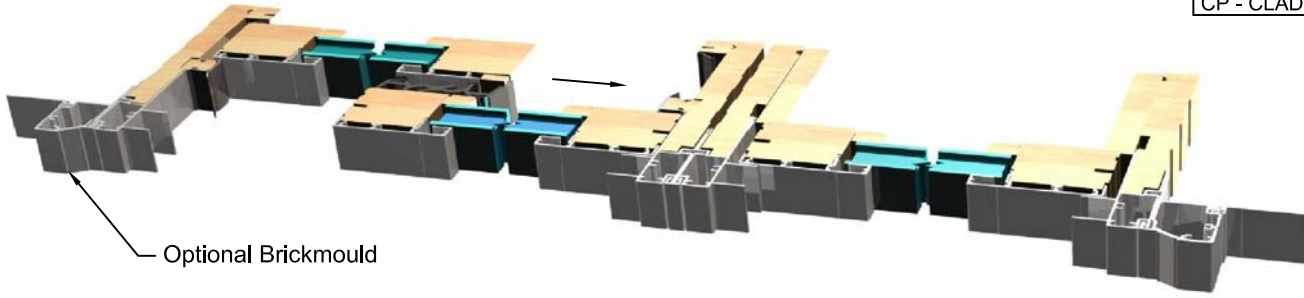

Optional Brickmould

Jamb Section
Scale: 1/4"=1"



Exterior Elevation
Scale: 1/2"=1'-0"

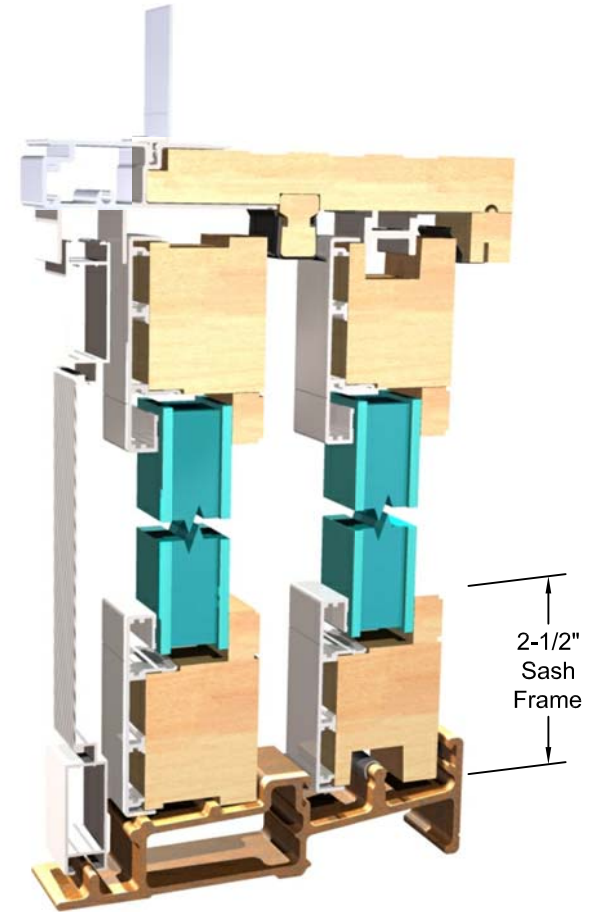

Head/Sill Section
Scale: 1/4"=1"

2-1/2"
Sash
Frame



Head/Sill Section @Stationary
Scale: 1/4"=1"

UNIT	OSM FRAME:	OSM OPTIONAL BRICKMOULD
CP7-6x6/9	90-1/2" x 80-1/16"	92-13/16" x 81-7/32"
CP9x6/9	108-1/2" x 80-1/16"	110-13/16" x 81-7/32"
CP12x6/9	144-1/2" x 80-1/16"	146-13/16" x 81-7/32"
CP7-6x6/11	90-1/2" x 82-1/16"	92-13/16" x 83-7/32"
CP9x6/11	108-1/2" x 82-1/16"	110-13/16" x 83-7/32"
CP12x6/11	144-1/2" x 82-1/16"	146-13/16" x 83-7/32"
CP7-6x8/0	90-1/2" x 95-1/16"	92-13/16" x 96-7/32"
CP9x8/0	108-1/2" x 95-1/16"	110-13/16" x 96-7/32"
CP12x8/0	144-1/2" x 95-1/16"	146-13/16" x 96-7/32"
Custom	Available	Frame Width + 2-5/16" Frame Height + 1-5/32"



PARK VUE
Wood Swing and Sliding Doors

BY MERRILL MILLWORK

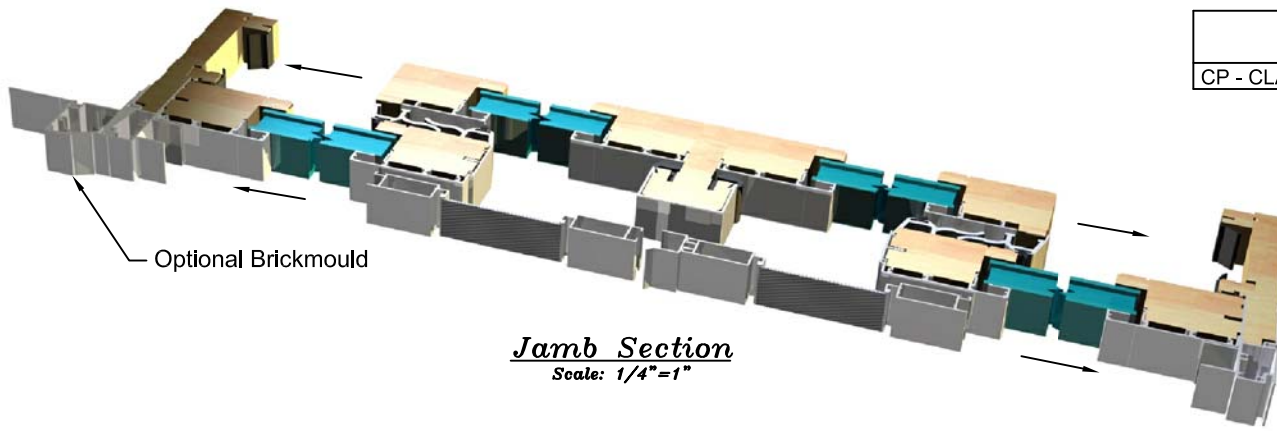

Optional Brickmould

Jamb Section
Scale: 1/4"=1"

DOOR TYPE	DESCRIPTION
CP - CLAD SLIDING GLASS DOOR	FOUR PANEL OXXO (SHOWN)



Exterior Elevation
Scale: 1/2"=1'-0"

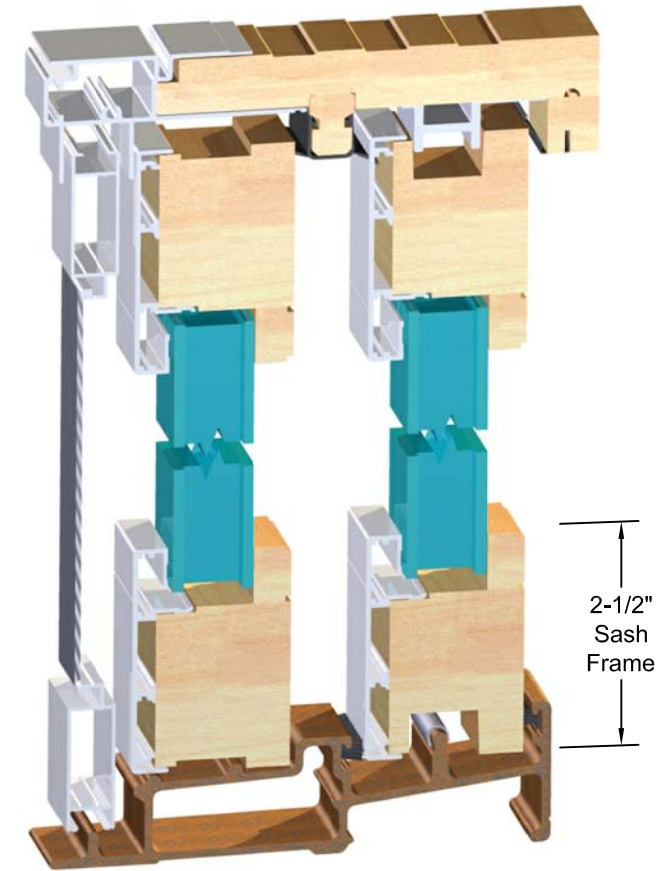

2-1/2"
Sash
Frame

Head/Sill Section
Scale: 1/4"=1"

UNIT	OSM FRAME:	OSM OPTIONAL BRICKMOULD
CP10-4x6/9	116-15/16" x 80-1/16"	119-1/4" x 81-7/32"
CP12-4x6/9	140-15/16" x 80-1/16"	143-1/4" x 81-7/32"
CP16-4x6/9	188-15/16" x 80-1/16"	191-1/4" x 81-7/32"
CP10-4x6/11	116-15/16" x 82-1/16"	131-1/4" x 83-7/32"
CP12-4x6/11	140-15/16" x 82-1/16"	155-1/4" x 83-7/32"
CP16-4x6/11	188-15/16" x 82-1/16"	203-1/4" x 83-7/32"
CP10-4x8/0	116-15/16" x 95-1/16"	119-1/4" x 96-7/32"
CP12-4x8/0	140-15/16" x 95-1/16"	143-1/4" x 96-7/32"
CP16-4 x 8/0	188-15/16" x 95-1/16"	191-1/4" x 96-7/32"
Custom	Available	Frame Width + 2-5/16" Frame Height + 1-5/32"



PARK VUE
Wood Swing and Sliding Doors

BY MERRILL MILLWORK

1300 W. TAYLOR ST. MERRILL, WI 54452 PHONE:(715) 536-8112 FAX:(715) 536-4329 www.Park-Vue.com

DOOR TYPE	DESCRIPTION
CP - CLAD "TELESCOPE" SLIDING GLASS DOOR	THREE PANEL OOX OR XXO

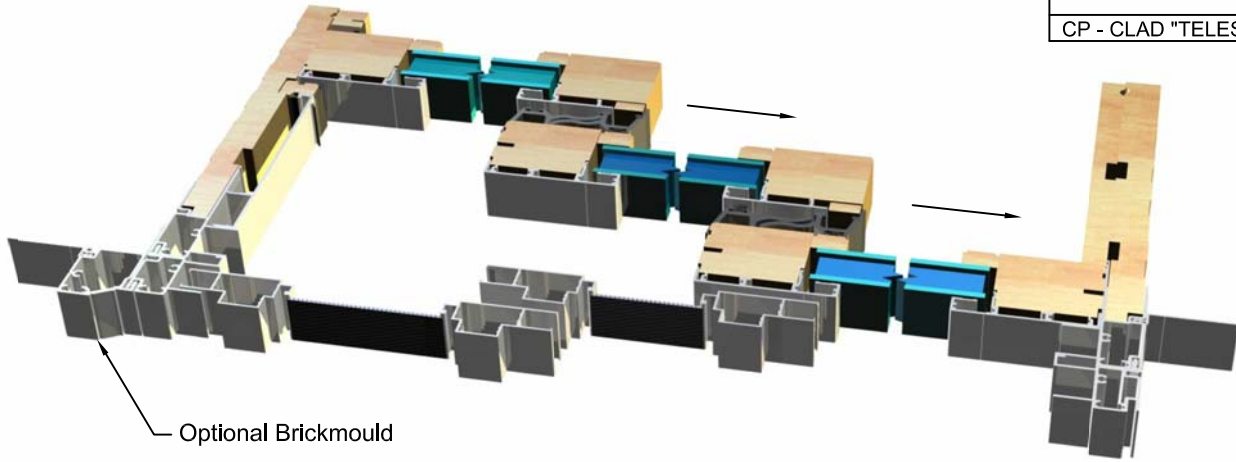

Optional Brickmould

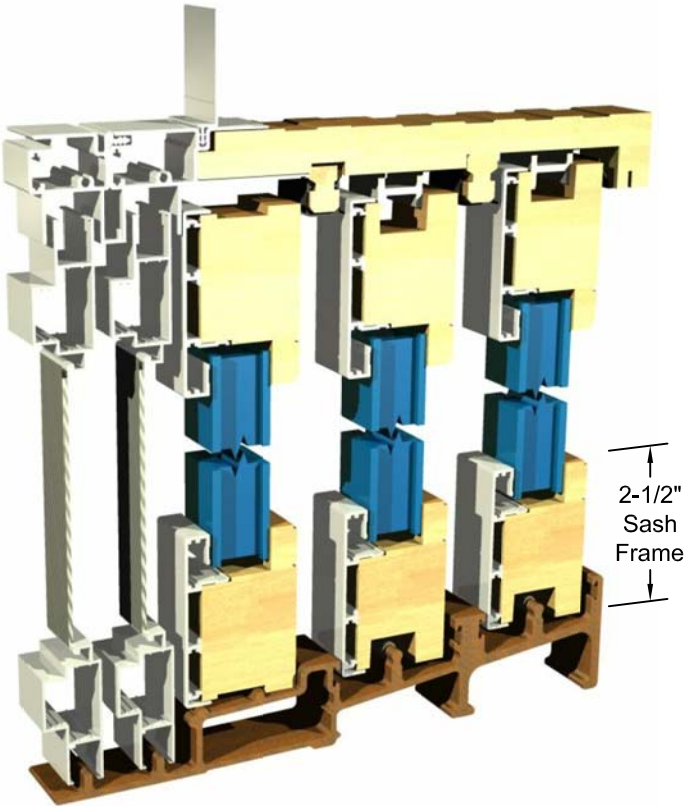

2-1/2"
Sash
Frame

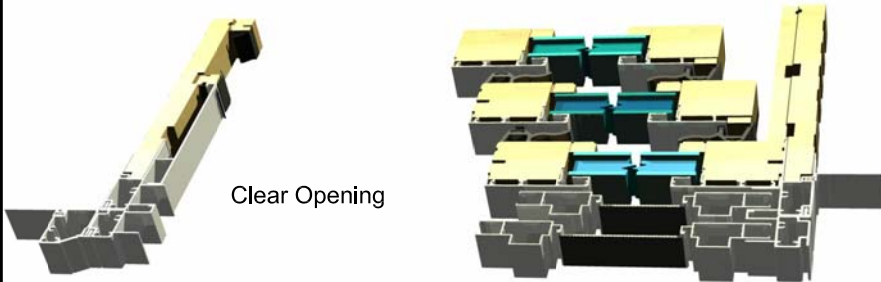

Clear Opening



Exterior Elevation
Scale: 1/2"=1'-0"

UNIT	OSM FRAME:	OSM OPTIONAL BRICKMOULD
TCP7-6x6/9	86-5/16" x 80-1/16"	88-5/8" x 81-7/32"
TCP9x6/9	104-5/16" x 80-1/16"	106-5/8" x 81-7/32"
TCP12x6/9	140-5/16" x 80-1/16"	142-5/8" x 81-7/32"
TCP7/6x6/11	86-5/16" x 82-1/16"	88-5/8" x 83-7/32"
TCP9x6/11	104-5/16" x 82-1/16"	106-5/8" x 83-7/32"
TCP12x6/11	140-5/16" x 82-1/16"	142-5/8" x 83-7/32"
TCP7/6x8	86-5/16" x 95-1/16"	88-5/8" x 96-7/32"
TCP9x8	104-5/16" x 95-1/16"	106-5/8" x 96-7/32"
TCP12x8	140-5/16" x 95-1/16"	142-5/8" x 96-7/32"
Custom	Available	Frame Width + 2-5/16" Frame Height + 1-5/32"



BY MERRILL MILLWORK